

Private Events



R.S. HISPANIOLA

RESTAURANT • BAR • VENUE

Welcome aboard

PRIVATE HIRE

If you are planning that perfect party, an important corporate event or your dream wedding, then we can make it truly memorable.

The R.S. Hispaniola offers unrivalled views over the River Thames, London Eye and Houses of Parliament. These views can be enjoyed from the open front and rear decks, from the fully air-conditioned restaurant and bar, and the Main Deck and Pinkton Parlour private hire spaces. Transport links to the Hispaniola are second to none. We are a two minute walk from Embankment tube and Charing Cross rail station. Waterloo and Westminster are five and ten minute walks respectively.

The Hispaniola has a light, yet intimate feel and offers great flexibility with its adaptable floor space, decks, bars and dining areas. But that is just the start; we offer a selection of options to choose from to personalise your event still further – from a DJ to a live band, a string quartet to a singer.

You can also brand the venue to suit your event. Choosing the Hispaniola is the easy way to host that perfect event that your guests will never forget.

All decks on Hispaniola are available for hire.* The ship also has a wedding Civil Ceremony licence for each of its indoor decks – Upper, Main and Officers' Mess.

**depending on the time of year*

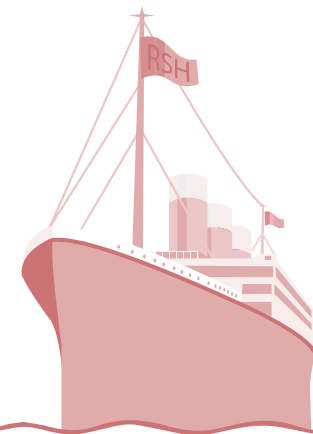

Main Deck & Pinkton Parlour Bar

(max capacity 150)

Our two-part space ensures you have the very best views of the River Thames.

The Pinkton Parlour Bar

Our gorgeous Art Deco Bar inspired area offers the perfect welcome to this mid deck space available for exclusive hire. Perfect for pre-dinner and post-dinner drinks, a break-out area, or casual seating, guests will then move into our Main Deck area. Mirrored pillars and cream tub chairs and sofas work well for any event.

Main Deck

We can do large boardroom style dinners for 20-40 people, with formal dining for up to 120 and parties for 150. Windows along the port side of the ship afford stunning views towards the London Eye, beautiful at night when illuminated. The deck space can be transformed with theming for your events and can also be used for 100 theatre style presentations, or cabaret/comedy performances.

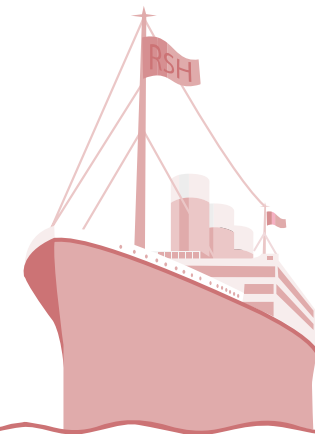

Upper Deck

(max capacity 100 Standing & 60 Seated for lunch or dinner)

From our stylish restaurant you have great views of the London Eye, the Houses of Parliament, St Paul's Cathedral and our wonderful River Thames.

It's for you to enjoy whilst having a good chat over a glass of wine or a cocktail. Due to the popularity of our restaurant this space is only available for use as part of a whole ship hire, or during the month of December.

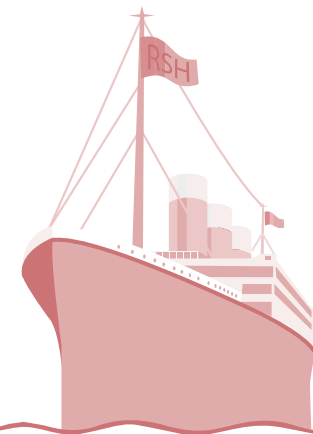

Officers' Mess

Evoking the style of a dining room for officers and situated in the hull of the ship, this room works very well for formal private dining for groups of 10-26.

Opting for an informal reception means your number can rise to 30.

You can have access to our outside space situated on the Upper Deck.



Whole Ship Hire (max capacity 300)

For larger events why not take over the entire Hispaniola? Enjoy reception drinks and entertainment on our Upper Deck, which has inside and outside spaces, followed by dinner on our Main Deck. This unique location has great views and is in central London with easy access to both overground rail and tube links.

Whole ship hire includes exclusive use of the following areas:

- Two inside areas (Main Deck and Upper Deck)
- Both the Front & Rear outside Decks
- Two bars – our Upper Deck bar area and Pinkton Parlour Bar on our Main Deck plus our Officers' Mess, great for breakout or a cloakroom solution.

	Reception	Seated
Officers' Mess	30	26
Main Deck*	150	120
Upper Deck	100	60
Whole Ship	300	180

Includes Pinkton Parlour Bar area*

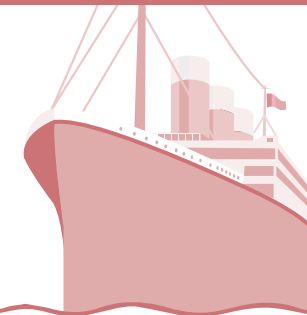

Deck plans 1

Upper Deck

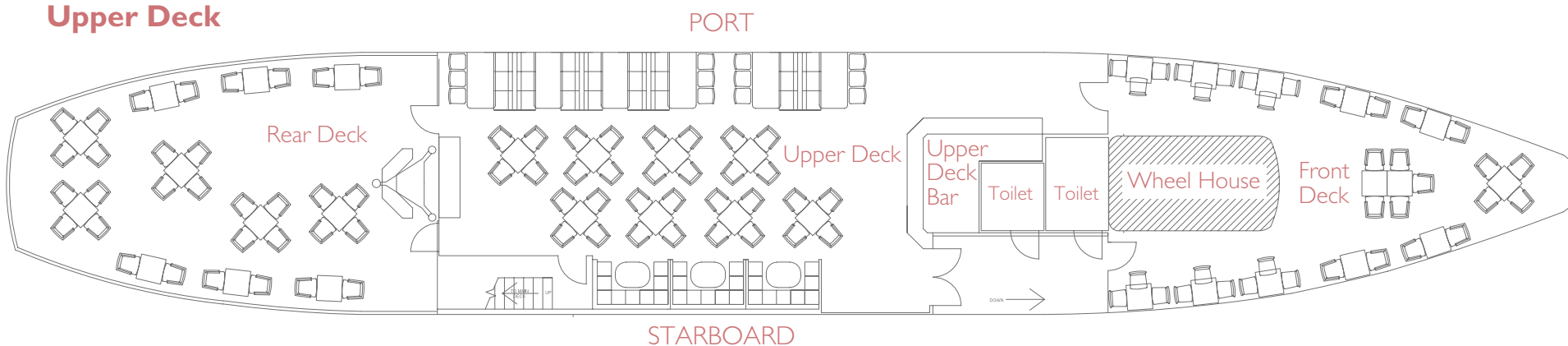

Main Deck

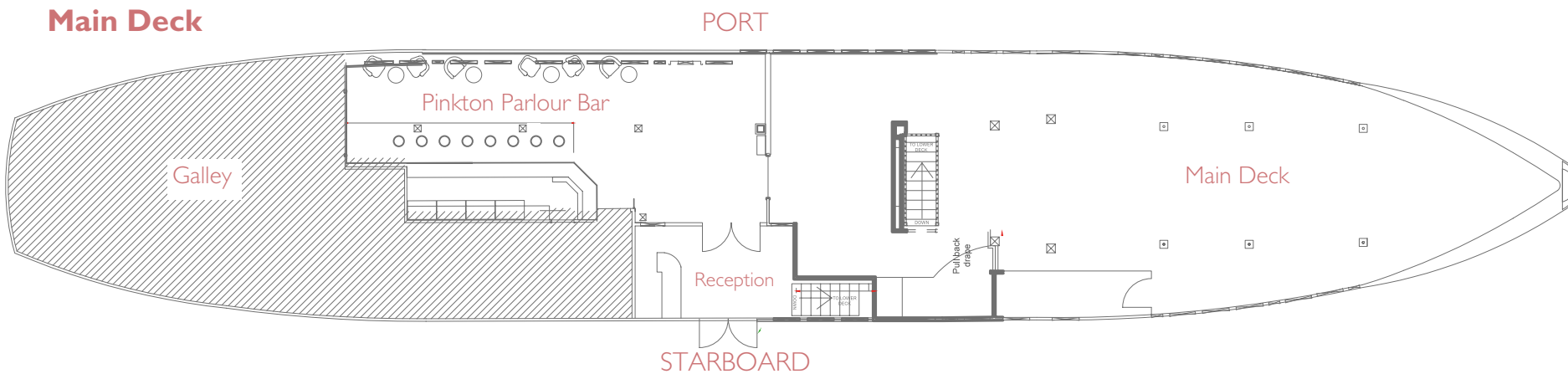

Deck plans 2

Lower Deck

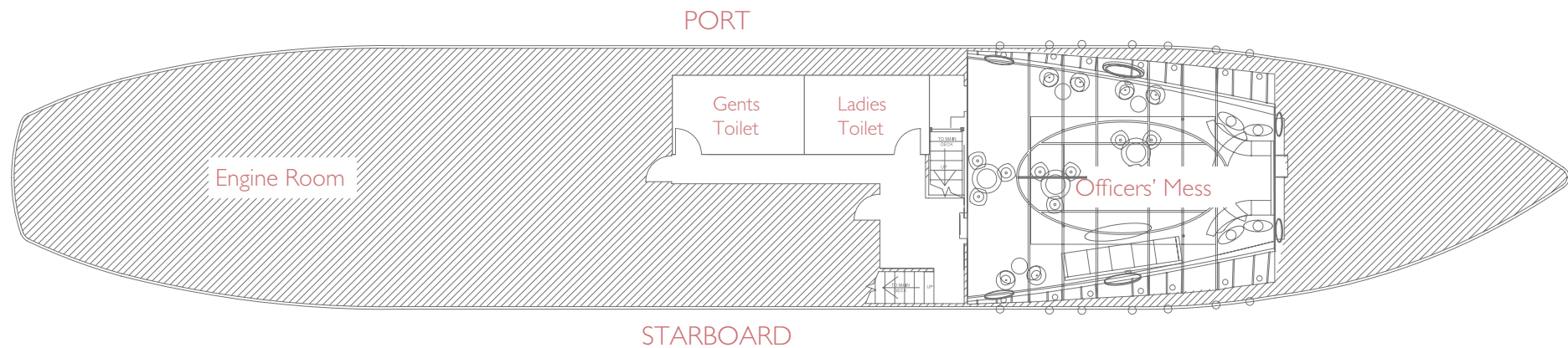

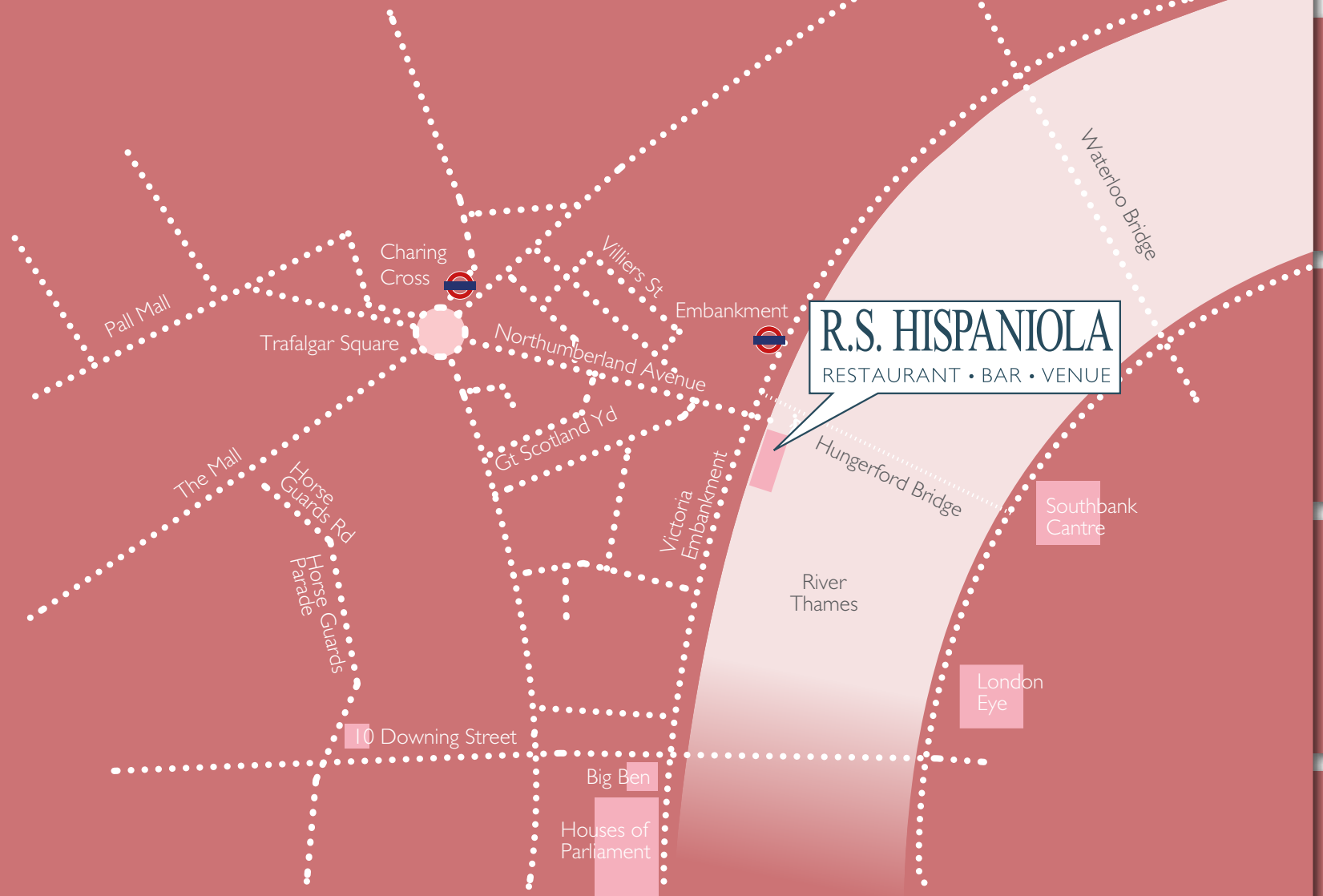

Contact Us

For information please contact us on
+44 (0)20 7740 0494 or the events team on +44 (0)20 7740 0411
or email: info@hispaniola.co.uk

R.S. Hispaniola Bar & Restaurant Victoria Embankment
London WC2N 5DJ

Welcome Aboard

Areas on Board

Deck Plans

Menus

Contact